



# Time management

Synchronising • Distributing • Displaying time

## Style 10S - Standard



MADE IN FRANCE

### PRESENTATION

- LED SMD indoor digital clock with built-in temperature sensor.
- Hour, minute and second display (HMS).
- Fixed time display, alternating with other information or timer display (with optional timer controller).
- Wall or bracket arm mounting (standard version).
- Available LED colours: red, green, yellow, blue and white.



Standard version

### COMPLIANCE

- Directives: LVD 2014/35/EU, EMC 2014/30/EU, RED 2014/53/EU, IEEE 802.11 b/g/n (NTP/Wi-Fi model).

### TECHNICAL FEATURES

#### General features

- Reading distance..... 60 m.
- Reading angle..... 160°
- Digits.....
  - Height: 10 cm (HM), 7 cm (S).
  - Design:
    - H: Hour
    - M: Minute
    - S: Second
  - HM separation..... Colon made of LEDs.
- Display.....
  - 12H or 24H mode.
  - With or without 0 for time, day, month (NTP/ETH model).
  - AM/PM indicator.
  - Timekeeping: Hour/Min/Sec from 0 to 23: 59: 59. Counting/Countdown.
- Alternating display.....
  - Date : day/month, month/day, month/year, Year/month, day/month/year, year/month/day.
  - Number: day of the year, week of the year.
  - Temperature: °C.
- Brightness..... 4 levels: 25%, 50%, 75% or 100%.
- Eco mode..... Programmable energy saving or Predefined over a time period. Brightness level can be adjusted in eco mode (NTP/ETH model).
- Time change..... Automatic summer/winter time changeover and perpetual calendar.
- Time base backup.....
  - Independent model: 15 days in case of power failure.
  - Impulse model: in case of power failure, data saving and impulse reception without battery.
  - NTP model: behaviour can be programmed in case of loss of synchronisation after more than 48h.
  - Other models: no backup. At each start up, the clock waits for a synchronisation signal.
- Time accuracy..... 0.1 sec /day at 25°C.
- Operation..... Silent.

- Configuration..... 2 touch-screen buttons.
- NTP/ETH and NTP/Wi-Fi models.....
  - Unicast, multicast and DHCP synchronisation.
  - Advanced and intuitive configuration from the embedded web server.

#### Mechanical features

- Construction..... Casing: Black ABS/PMMA. Other colours upon request. Glass: Anti-glare PMMA glass (matte finish)
- Protection index..... IP40, IK07
- Operating temperature.... -5°C to +55°C.
- Weight..... 2.8 kg.
- Dimensions..... See hereinafter.

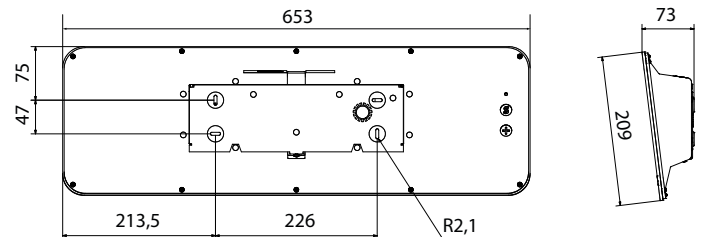

Dimensions in mm

#### Electrical features

- Power supply.....
  - Independent, impulse, AFNOR, DHF radio and NTP/Wi-Fi models: 100-240V~.
  - ALS+ DCF radio model: 230V~.
  - NTP/ETH model: PoE (Power over Ethernet) – Class 0.
- Max consumption .....
  - 100-240V~, 250-150 mA.
  - 230V~, 60 mA.
  - NTP/ETH model:
    - red, green, yellow: 6W.
    - blue, white: 2W.
- Electrical protection..... NTP/ETH model: Class 3. Other models: Class 2.



# Time management

Synchronising • Distributing • Displaying time

## Style 10S - Standard



### REFERENCES - STYLE 10S STANDARD

946 81x.....	Independent model.
946 82x.....	Impulse model
946 83x.....	ALS+ DCF model.
946 84x.....	DHF model.
946 85x.....	AFNOR model.
946 87x.....	NTP/ETH model
946 88x.....	NTP/Wi-Fi model.

Replace the "x" in the reference number to specify the LED colour:



### ACCESSORIES - STYLE 10S STANDARD

946 005.....	Double-sided bracket arm
946 006.....	Single-sided bracket arm.
946 051.....	Style timer controller.
946 080.....	External Wi-Fi antenna.

Bracket arm mounting (ceiling or mast)

- Construction..... Black steel.

Bracket arm (single-sided mounting)



Bracket arm (double-sided mounting)



Dimensions in mm



# Time management

Synchronising • Distributing • Displaying time

## Style 10S - Waterproof



MADE IN FRANCE

### PRESENTATION

- LED SMD indoor digital clock.
- Hour, minute and second display (HMS).
- Operation and electronics similar to a standard Style 10S.  
The mechanics differ to ensure IP65 watertightness.
- Available LED colours: red.



Waterproof version

### COMPLIANCE

- Directives: LVD 2014/35/EU, EMC 2014/30/EU, RED 2014/53/EU.

### TECHNICAL FEATURES

#### General features

- Similar to Style 10S standard.

#### Mechanical features

- Similar to Style 10S standard.
- Construction..... Waterproof grommets and silicone seals installed between the bracket and the clock's casing.
- Protection index..... IP65, IK07
- Dimensions..... See hereinafter.

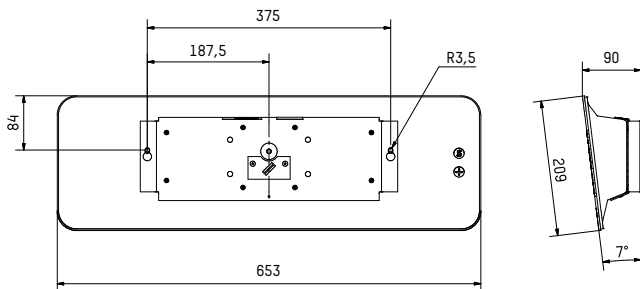

Dimensions in mm

#### Electrical features

- Similar to Style 10S standard.

### REFERENCES - STYLE 10S WATERPROOF

946 871 A..... NTP/ETH model